

Metric units of Measure

RCR Multiple Unit Assemblies
 82.5 mm to 89 mm Hanger rod diameter
 20865-29937 kilogram capacity

E* refers only to the uppermost blocking position.
 Downward travel increases E dimension directly.

Hanger rod provided in U.S. customary units.
 See rod diameter in tables below.

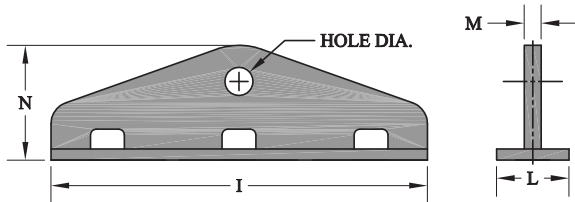

Top and Bottom Lug Plates

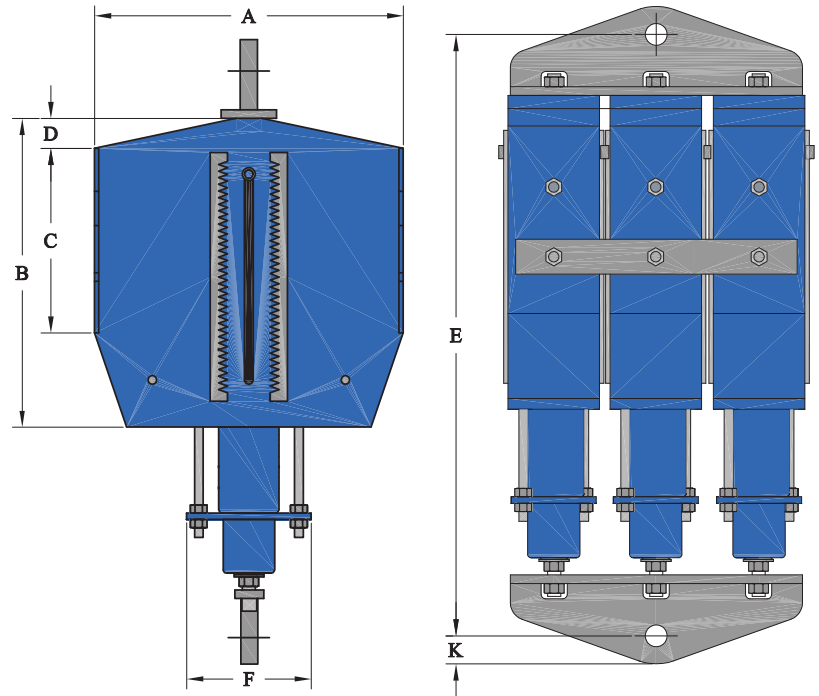

RILCO CAM ROLLER™ Identifier	A	B	C	D	E*	F	H	I	K	L	M	N	Hole Dia.	Rod Diameter	Est. Unit Wt kg.
RCR 46000-12	1245	1118	743	127	2686	419	933	857	108	83	35	311	86	82.5 (3-1/4")	2372
RCR 46000-18	1302	1626	851	248	3188	419	953	870	108	83	35	311	86	82.5 (3-1/4")	3074
RCR 52000-3	857	584	330	51	1308	387	933	857	108	83	35	311	86	82.5 (3-1/4")	958
RCR 52000-6	991	718	343	216	1740	387	933	857	108	83	35	311	86	82.5 (3-1/4")	1267
RCR 55000-12	1283	959	381	381	2394	457	1022	933	121	89	35	349	98	89 (3-1/2")	2247
RCR 58000-18	1353	1619	800	292	3359	457	1041	953	121	89	35	349	98	89 (3-1/2")	3621
RCR 66000-3	908	629	349	51	1422	438	1022	933	121	89	35	349	98	89 (3-1/2")	1214
RCR 66000-6	1143	787	356	248	1848	438	1022	933	121	89	35	349	98	89 (3-1/2")	1639
RCR 66000-12	1302	1092	584	248	2819	457	1041	953	121	89	35	349	98	89 (3-1/2")	2810

All dimensions shown are in millimeters U.N.O.