

U.S. Customary Units

RCR Multiple Unit Assemblies  
 3-1/2" to 4" Hanger rod diameter  
 62000-120000 pound capacity

E\* refers only to the uppermost blocking position.  
 Downward travel increases E dimension directly.

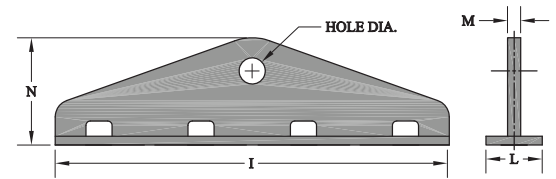
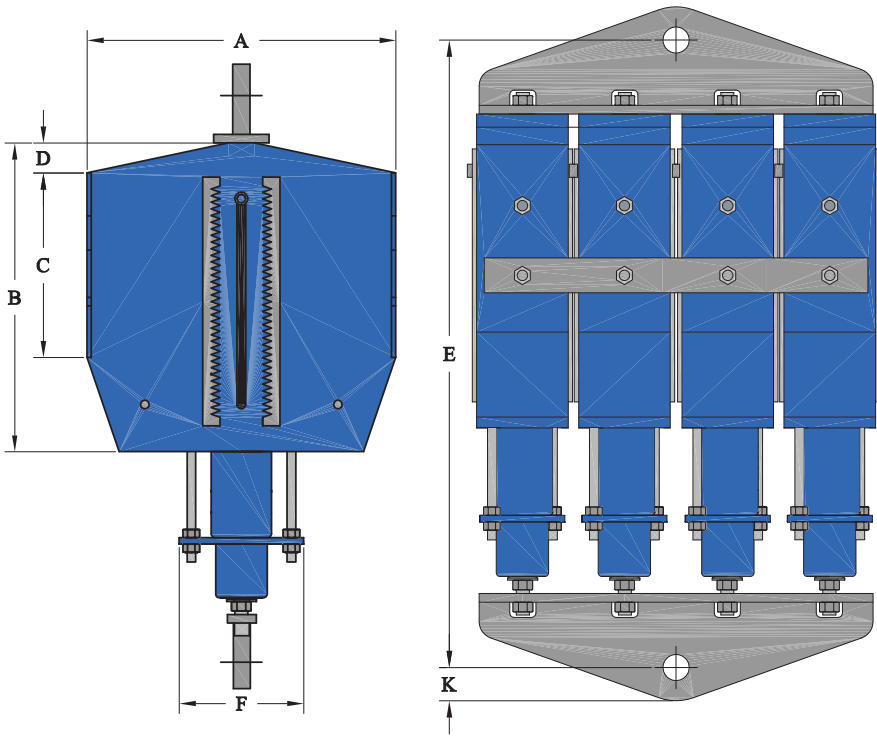

Top and Bottom Lug Plates

RILCO CAM ROLLER™ Identifier	A	B	C	D	E*	F	H	I	K	L	M	N	Hole Dia.	Est. Unit Wt lbs.	Rod Diameter
RCR 62000-18	51.25	64	33.5	9.75	128.5	16.5	49.25	46.00	4.75	3.25	1.375	14.5	3.875	9095	3-1/2 UNC
RCR 70000-3	33.75	23	13	2	54.5	15.25	48.50	45.50	4.75	3.25	1.375	14.5	3.875	2870	3-1/2 UNC
RCR 70000-6	39	28.25	13.5	8.5	71.75	15.25	48.50	45.50	4.75	3.25	1.375	14.5	3.875	3780	3-1/2 UNC
RCR 70000-12	50.5	37.75	15	15	95.75	18	53.25	49.75	5.25	3.50	1.375	15	4.375	6710	4 UNC
RCR 74000-18	53.25	63.75	31.5	11.5	133.75	18	54.25	50.50	5.25	3.50	1.375	15	4.375	10740	4 UNC
RCR 88000-3	35.75	24.75	13.75	2	57.5	17.25	53.25	49.75	5.25	3.50	1.375	15	4.375	3670	4 UNC
RCR 88000-6	45	31	14	9.75	74.5	17.25	53.25	49.75	5.25	3.50	1.375	15	4.375	4920	4 UNC
RCR 88000-12	51.25	43	23	9.75	112.5	18	54.25	50.50	5.25	3.50	1.375	15	4.375	8360	4 UNC

All dimensions shown are in inches U.N.O.

\*\*Contact Rilco for loads higher than 88000 lbs.