

**Metric Units of Measure**

RCR Multiple Unit Assemblies  
 89 mm to 101.6 mm Hanger rod diameter  
 28122-54431 kilogram capacity

E\* refers only to the uppermost blocking position.  
 Downward travel increases E dimension directly.

Hanger rod provided in U.S. customary units.  
 See rod diameter in tables below.

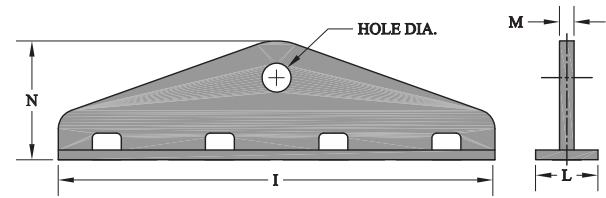
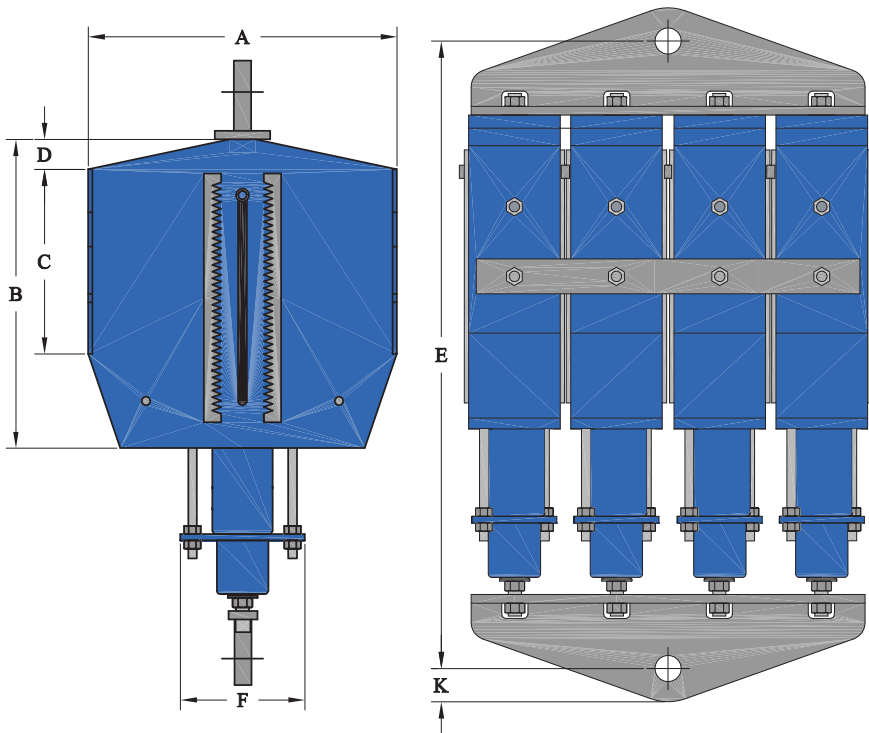

Top and Bottom Lug Plates

RILCO CAM ROLLER™ Identifier	A	B	C	D	E*	F	H	I	L	M	K	N	Hole Dia.	Rod Diameter	Est. Unit Wt kg.
<b>RCR 62000-18</b>	1302	1626	851	248	3264	419	1251	1168	83	35	121	368	98	89 (3-1/2")	4129.1
<b>RCR 70000-3</b>	857	584	330	51	1384	387	1232	1156	83	35	121	368	98	89 (3-1/2")	1303.0
<b>RCR 70000-6</b>	991	718	343	216	1822	387	1232	1156	83	35	121	368	98	89 (3-1/2")	1716.1
<b>RCR 70000-12</b>	1283	959	381	381	2432	457	1353	1264	89	35	133	381	111	101.6 (4")	3046.3
<b>RCR 74000-18</b>	1353	1619	800	292	3397	457	1378	1283	89	35	133	381	111	101.6 (4")	4876.0
<b>RCR 88000-3</b>	908	629	349	51	1461	438	1353	1264	89	35	133	381	111	101.6 (4")	1666.2
<b>RCR 88000-6</b>	1143	787	356	248	1892	438	1353	1264	89	35	133	381	111	101.6 (4")	2233.7
<b>RCR 88000-12</b>	1302	1092	584	248	2858	457	1378	1283	89	35	133	381	111	101.6 (4")	3795.4

**All dimensions shown are in millimeters U.N.O.**

**\*\*Contact Rilco for loads higher than 54431 kilograms.**