

PART# 660

Pipe Supports Pipe Saddle Support

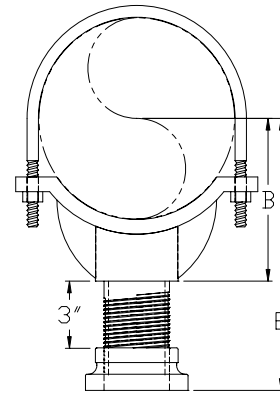
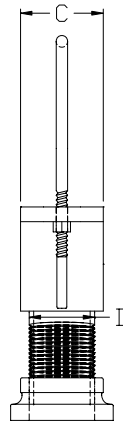

SIZE RANGE: 4" to 36" inches.

MATERIAL: Carbon Steel

FINISH: Black, Galvanized, or coated to customers specifications.

SERVICE: Stanchion type support where vertical adjustment of stationary pipe is needed.

APPROVALS: Complies with Manufacturers Standardization Society SP-69 (Type 37)

INSTALLATION: Adjustment is made by turning the locknut. The lower end of the locknut is staked, upsetting the threads to prevent separation of locknut and coupling during adjustment.

ORDERING: Specify part number, name, finish and pipe size to be supported.

Load (lbs) • Weight (lbs) • Dimensions (inches)

Pipe size	Weight	B	C	D	E	
					Minimum	Maximum
4	22.0	4 ³ / ₁₆	3 ⁵ / ₈	3	9 ¹ / ₂	14
5	23.1	4 ¹³ / ₁₆			10 ¹ / ₈	14 ⁵ / ₈
6	23.9	5 ⁷ / ₁₆			10 ³ / ₄	15 ¹ / ₄
8	32.5	6 ¹⁵ / ₁₆			12 ¹ / ₄	16 ³ / ₄
10	36.9	8 ⁷ / ₁₆			13 ³ / ₄	18 ¹ / ₄
12	42.4	9 ¹⁵ / ₁₆			14 ⁵ / ₈	19 ¹ / ₈
14	39.2	10 ¹ / ₂	6	3 ¹ / ₂	15 ¹³ / ₁₆	20 ⁵ / ₁₆
16	42.2	11 ¹ / ₂			16 ¹³ / ₁₆	21 ⁵ / ₁₆
18	60.0	13 ¹ / ₂			19 ¹ / ₈	23 ⁵ / ₈
20	63.0	14 ¹ / ₂			20 ¹ / ₈	24 ⁵ / ₈
24	72.0	17 ¹ / ₂		4	23 ⁵ / ₁₆	27 ¹³ / ₁₆
30	89.0	20 ⁵ / ₈			26 ⁷ / ₁₆	30 ¹⁵ / ₁₆
32	93.0	21 ⁵ / ₈			27 ⁷ / ₁₆	31 ¹⁵ / ₁₆
36	101.0	23 ⁵ / ₈			29 ⁷ / ₁₆	33 ¹⁵ / ₁₆