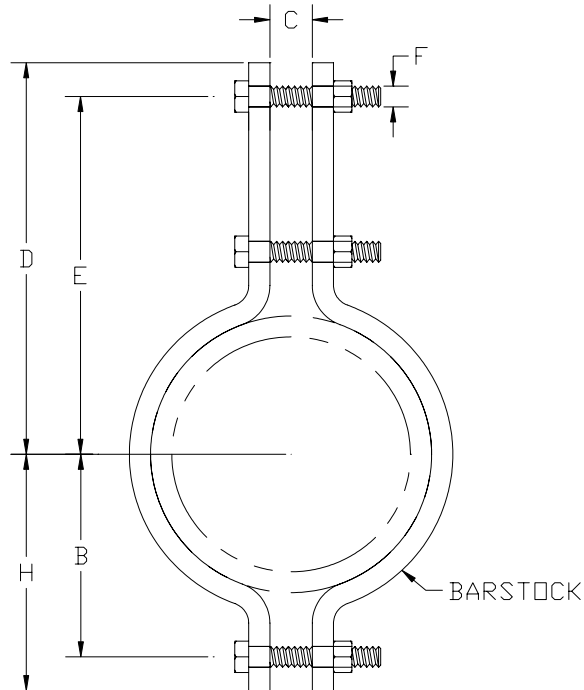

Part # 363**Non-Standard Three Bolt Pipe Clamp**

MATERIAL TYPES: Carbon Steel, chrome molybdenum or stainless steel.

FINISH: Black, Galvanized, or coated to customer specifications.

APPLICATIONS: Recommended for suspension of high temperature pipe requiring insulation.

MAXIMUM TEMPERATURE: As required

ORDERING: RILCO part #363 Double Bolt Pipe Clamp, material type, pipe size, load, operating temperature, insulation thickness. Alloy clamps, unless otherwise specified, will be furnished with alloy studs made from ASTM spec. A-193-B7 stud stock with the center third unthreaded, and hex nuts.